



**Wight to hold:**

**Under 150Kg 1 x # 2510 stern + 1x # 2510 bow;**

**From 150Kg to 200Kg 2x # 2505 stern + 1x # 2510 bow;**

**From 200Kg to 250Kg 2x # 2505 stern + 2x # 2500 bow;**

**From 250Kg to 300Kg 2x # 2505 stern + 2x # 2505 bow;**

**Above 300Kg add 2x # 2505 every 50 Kg**



G45, 76-84 WATERWAY DRIVE COOMERA, QUEENSLAND, 4209, AUSTRALIA

PHONE: (+61) 7 5556 0244

EMAIL: SALES@GINEICOMARINE.COM.AU

WWW.GINEICOMARINE.COM.AU

# CHOCKS

single arch item #2500 and #2500F

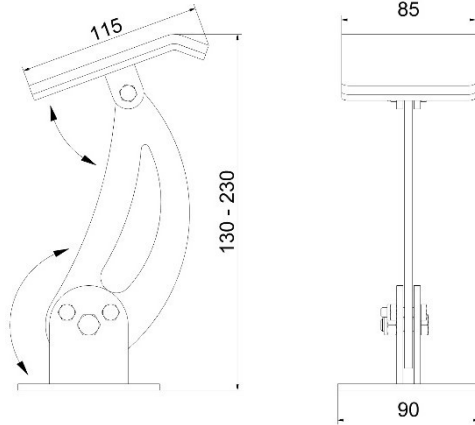

ART #2500F

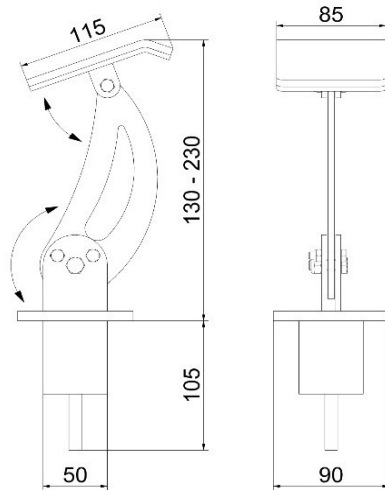

ART #2500

## Description:

Universal layout hard hull chock made of mirror-polished 316L stainless steel. There are many different inclination angles possible, they can be adjusted manually depending on the hull shape and the selected position can be fixed with a screw and a nut. The inclination angle of the plate is manually adjustable; the plate is covered by a special gum surface to reduce friction and scratches on the hull. 3 different chocks models are available: single arch, double arch and double counterposed arch.

The bottom part of the chock can be fixed without recess (#2500 F) or built-in to the deck into a socket with a draining hole (#2500).

Thanks to its particular shape, this chock can virtually fit a multitude of hard hull designs such as tenders, watercraft or Jet Ski and can be adjusted with a simple movement, without having to move the installed bases.

The extractable version is supplied with the built-in socket



  
**GINEICO**

made in Italy

# CHOCKS double arch item #2505 and #2505F

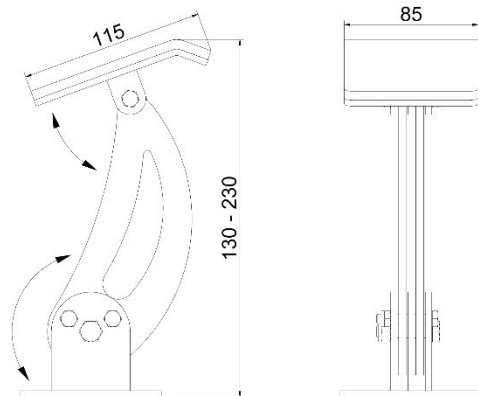

ART #2505F

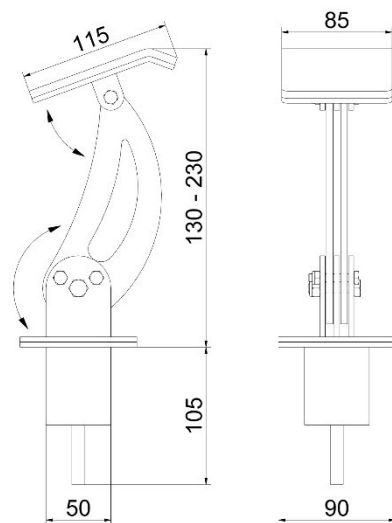

ART #2505

## Description:

Universal layout hard hull chock made of mirror-polished 316L stainless steel. There are many different inclination angles possible, they can be adjusted manually depending on the hull shape and the selected position can be fixed with a screw and a nut. The inclination angle of the plate is manually adjustable; the plate is covered by a special gum surface to reduce friction and scratches on the hull. 3 different chocks models are available: single arch, double arch and double counterposed arch.

The bottom part of the chock can be fixed without recess (#2505 F) or built-in to the deck into a socket with a draining hole (#2505). Thanks to its particular shape, this chock can virtually fit a multitude of hard hull designs such as tenders, watercraft or Jet Ski and can be adjusted with a simple movement, without having to move the installed bases.

The extractable version is supplied with the built-in socket



  
GINEICO

made in Italy

# CHOCKS

double counterposed arches item #2510 and #2510F

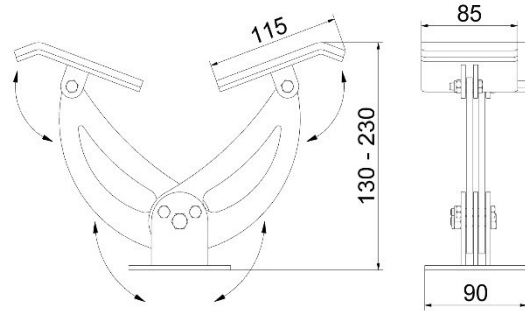

ART #2510F

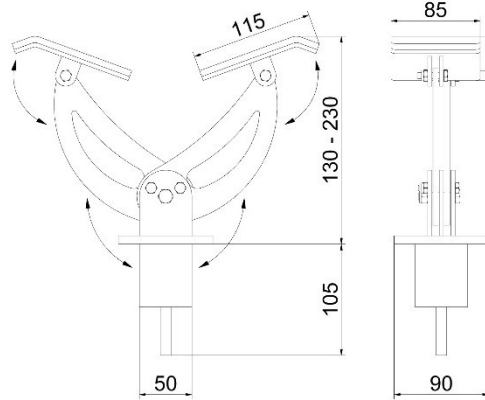

ART #2510

## Description:

Universal layout hard hull chock made of mirror-polished 316L stainless steel. There are many different inclination angles possible, they can be adjusted manually depending on the hull shape and the selected position can be fixed with a screw and a nut. The inclination angle of the plate is manually adjustable; the plate is covered by a special gum surface to reduce friction and scratches on the hull. 3 different chocks models are available: single arch, double arch and double counterposed arch.

The bottom part of the chock can be fixed without recess (#2510 F) or built-in to the deck into a socket with a draining hole (#2510). Thanks to its particular shape, this chock can virtually fit a multitude of hard hull designs such as tenders, watercraft or Jet Ski and can be adjusted with a simple movement, without having to move the installed bases.

The extractable version is supplied with the built-in socket



  
**GINEICO**

made in Italy